

選購品/噴氣嘴

● 直噴氣嘴

N51-01 單獨式 $\phi 2.5$

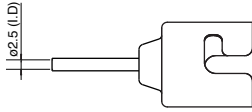

N51-02 單獨式 $\phi 4$

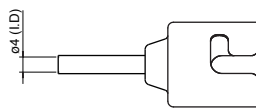

N51-03 單獨式 $\phi 5.5$

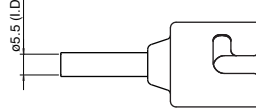

N51-04 單獨式 $\phi 7$

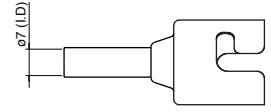

N51-05 彎曲單管 1.5x3

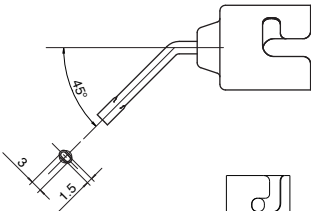

N51-50

附 N51-01, N51-03, N51-04, N51-05

● BGA 噴氣嘴

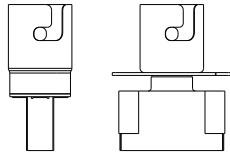

N51-10 BGA 4 x 4

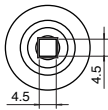

N51-11 BGA 6 x 6

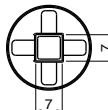

N51-12 BGA 8 x 8

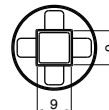

N51-13 BGA 10 x 10

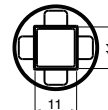

N51-14 BGA 12 x 12

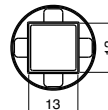

N51-15 BGA 14 x 14

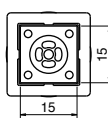

N51-16 BGA 15 x 15

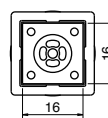

N51-17 BGA 17 x 17

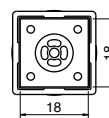

N51-18 BGA 18 x 18

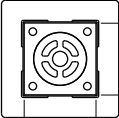

N51-19 BGA 20 x 20

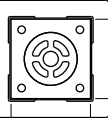

N51-20 BGA 22 x 22

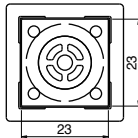

N51-21 BGA 24 x 24

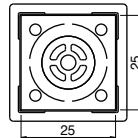

N51-22 BGA 27 x 27

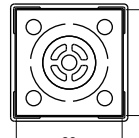

N51-23 BGA 29 x 29

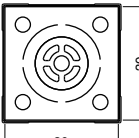

N51-24 BGA 35 x 35

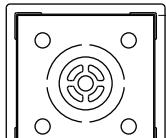

N51-25 BGA 38 x 38

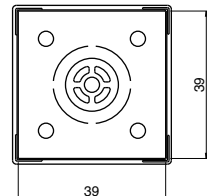

N51-26 BGA 40 x 40

